

4206 Union Deposit Road
Harrisburg, PA 17111
Lower Paxton Township

Free Standing Building
1,976 s.f. w/ 1,500 s.f. canopy



- Centrally located to serve the most densely populated area of Harrisburg's East Shore
- Conveniently located next to the Point Shopping Center, anchored by Giant, Burlington, & Staples
- Easy access from I-83, close proximity to I-283, I-81 & 322
- Zoning CG - General Commercial; permits office, medical labs, personal services, financial institution, etc.
- Level topography; 11 parking spaces with 12 in common



750 East Park Drive
Harrisburg, PA 17111
717-564-0832 Office
717-564-4759 Fax

uniondepositcorporation.com

BUILDING – BANK BRANCH CLOSED

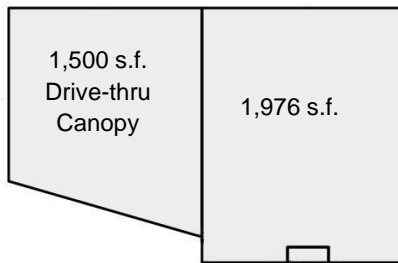
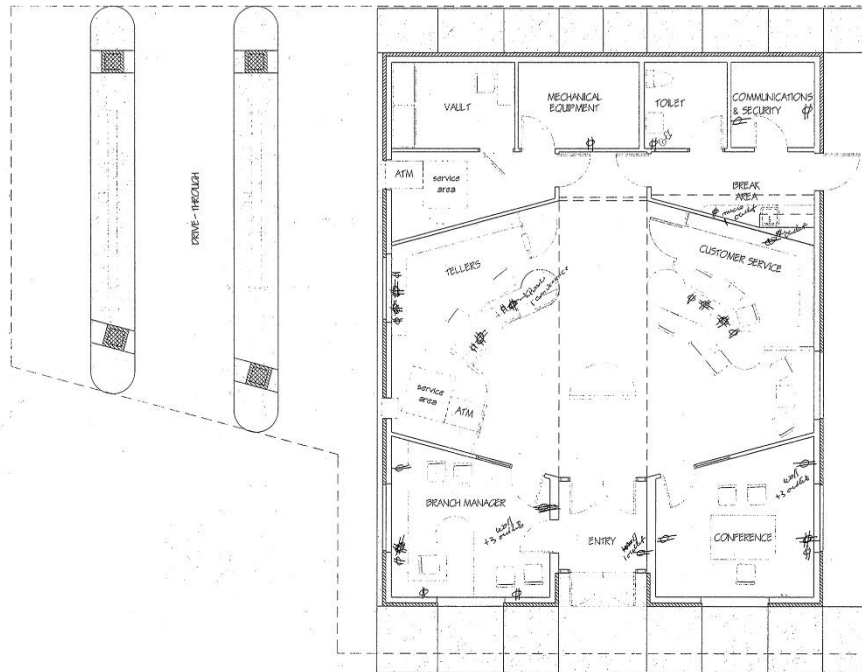

DESCRIPTION

Location Description

Address: 4206 Union Deposit Rd
Harrisburg, PA 17111
County: Dauphin
Municipality: Lower Paxton Township
Tax Parcel #: 35-075-076
Access: Union Deposit Road

Building Description

Total s.f./Avail s.f.: 1,976 s.f. w/1,500 s.f. drive-thru canopy
Build Out: "As Is"
Class: B
Construction: Brick w/Block Back-up
of Units: 1
Age: Built 1995
Roof Type/Material: Standing Seam Metal Roof
Floor Type/Material: Cement/Carpet & Vinyl

Building Description

Floors: 1
Elevator: 0
Ceiling Hgt min/max: 9' /15'
Type: Acoustical tile
Sprinklers: Yes
Lighting: Fluorescent
HVAC/Source: Forced hot air; central AC
Restrooms: Men's & Women's handicapped
Business ID Sign: Yes
Parking Spaces: 11 with 12 in common
Handicap Access: Yes

Site Description:

Zoning: CG-General Commercial
Topography: Level
Public Transportation: Yes