



Bonnydale Plaza
Harrisburg, PA

FOR LEASE - 717-564-0832

Location Description

Address: Bonnydale Plaza
989 East Park Drive
Harrisburg, PA 17111

Cross Street: N/A
County: Dauphin
Municipality: Lower PaxtonTwp
Tax Parcel #: 35-074-009
Directions: I-83 to Union Deposit
Road exit, East Park
Drive, property on left
East Park Drive

Access: East Park Drive

Building Description

Space Available: Up to 3,600 s.f.
Build Out: "As Is"
Class: B+
Construction: Brick masonry
of Units:
Age: Built 1979
Roof Type/Material: Flat/Rubber
Floor Type/Material: Carpet/Vinyl
Floors: 1
Elevator: 0
Ceiling Hgt min/max: 10' /10'
Type: Acoustical tile
Sprinklers: No
Lighting: Fluorescent
HVAC/Source: Forced hot air; central
AC / Gas and Electric

Restrooms: Men's & Women's
handicapped

Business ID Sign: Yes
Parking Spaces:
Handicap Access: Yes
Parking Description: In Common

Site Description:

Frontage: Along East Park Drive
Zoning: C-3 Commercial Mixed
Topography: Graded
Public Transportation: Yes

Utilities/Services Paid Directly By

Water:	CAM	Janitorial:	T
Sewer:	CAM	Heat:	T
Trash:	T	HVAC Repairs:	T
Electricity:	T	In-Suite Repairs:	T
Air Conditioning:	T	Parking Maint & Lights	CAM
Plumbing Repair:	T	Structure Repairs:	L
Lawn Maint:	CAM	Snow Removal:	CAM
Taxes:	CAM	In Suite Light Bulbs:	T
Insurance:	CAM	Roof	L

T Tenant pays directly
TB Tenant responsible, LL pays & bills Tenant
L Landlord's sole expense
CAM Common Area Maintenance
LL pays; charged to Tenant's pro rata share of CAM

Utility	Provider	Location	Size/Capacity
Electricity:	PPL	On Site	
Gas:	UGI	On Site	N/A
Water:	Public	On Site	N/A
Sewer:	Public	On Site	N/A

Comments

Special Features:
Remarks: Ideal for retail, service oriented business, or office use.

Lease Rate/Terms

S.F.	Rate:	Term:	Comments:
2,400 Suite A		5 years	
1,200 Suite B		5 years	
3,750 Suite D		5 years	



750 East Park Drive
Harrisburg, PA 17111
717-564-0832 Telephone
717-564-4759 Fax

Information deemed reliable, but no warranty is made as to the accuracy thereof, and it is submitted subject to errors, omissions, change of price or other conditions, prior sale or lease, or withdrawal without notice. All sizes approximate.

SITE PLAN

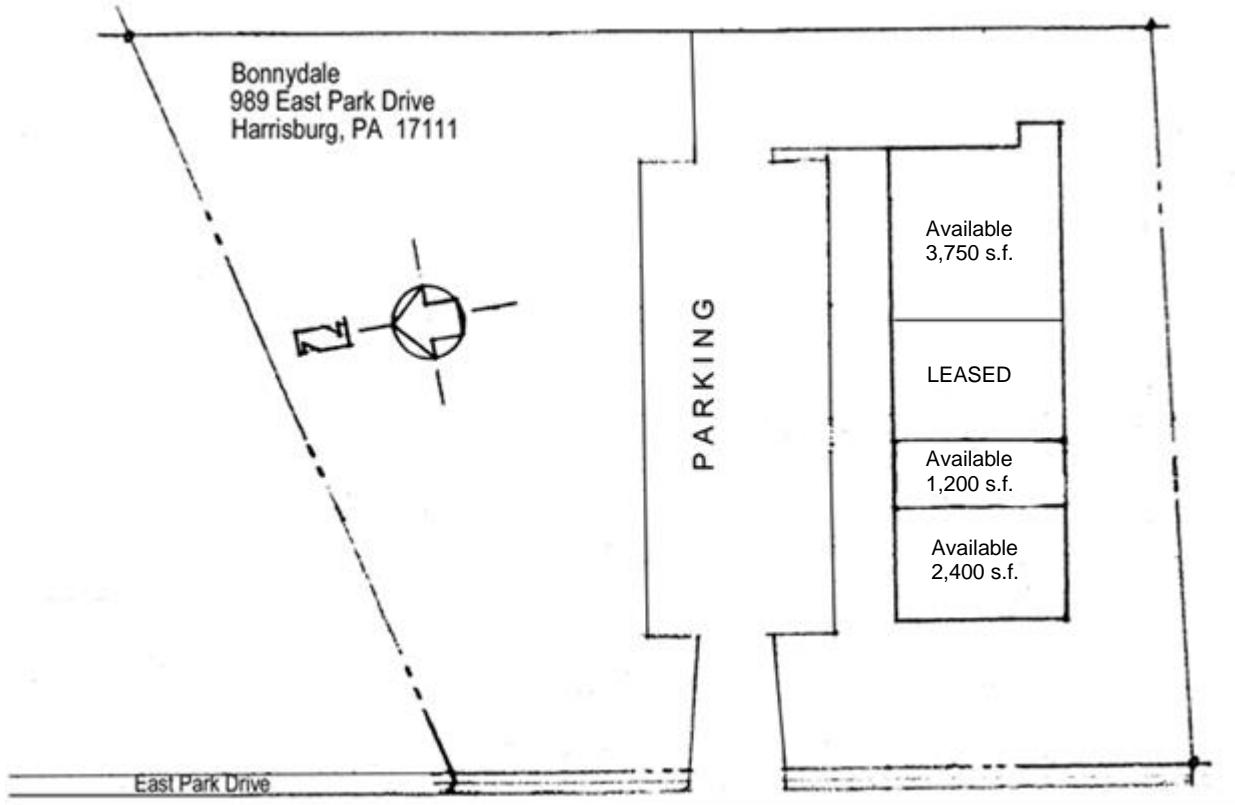

LOCATION – BONNYDALE PLAZA – 989 EAST PARK DRIVE, HARRISBURG, PA

